

KEY TO MAP

- 500-Year Flood Boundary ——— ZONE B
- 100-Year Flood Boundary ——— ZONE A1 DATE
- Zone Designations* With Date of Identification e.g. 1/2/74 ——— ZONE A5 DATE
- 100-Year Flood Boundary ——— ZONE B
- 500-Year Flood Boundary ——— ZONE B
- Base Flood Elevation Line With Elevation In Feet** ——— 513
- Base Flood Elevation in Feet Where Uniform Within Zone** (EL 987)
- Elevation Reference Mark ——— RM7x
- River Mile ——— M1.5

**Referenced to the National Geodetic Vertical Datum of 1929

*EXPLANATION OF ZONE DESIGNATIONS

- | ZONE | EXPLANATION |
|--------|--|
| A | Areas of 100-year flood; base flood elevations and flood hazard factors not determined. |
| A0 | Areas of 100-year shallow flooding where depths are between one (1) and three (3) feet; average depths of inundation are shown, but no flood hazard factors are determined. |
| AH | Areas of 100-year shallow flooding where depths are between one (1) and three (3) feet; base flood elevations are shown, but no flood hazard factors are determined. |
| A1-A30 | Areas of 100-year flood; base flood elevations and flood hazard factors determined. |
| A99 | Areas of 100-year flood to be protected by flood protection system under construction; base flood elevations and flood hazard factors not determined. |
| B | Areas between limits of the 100-year flood and 500-year flood; or certain areas subject to 100-year flooding with average depths less than one (1) foot or where the contributing drainage area is less than one square mile; or areas protected by levees from the base flood. (Medium shading) |
| C | Areas of minimal flooding. (No shading) |
| D | Areas of undetermined, but possible, flood hazards. |
| V | Areas of 100-year coastal flood with velocity (wave action); base flood elevations and flood hazard factors not determined. |
| V1-V30 | Areas of 100-year coastal flood with velocity (wave action); base flood elevations and flood hazard factors determined. |

NOTES TO USER

Certain areas not in the special flood hazard areas (zones A and V) may be protected by flood control structures.
 This map is for flood insurance purposes only; it does not necessarily show all areas subject to flooding in the community or all planimetric features outside special flood hazard areas.
 For adjoining map panels, see separately printed Index To Map Panels.

INITIAL IDENTIFICATION:

JUNE 10, 1977

FLOOD HAZARD BOUNDARY MAP REVISIONS:

FLOOD INSURANCE RATE MAP EFFECTIVE DATE: SEPTEMBER 2, 1981

FLOOD INSURANCE RATE MAP REVISIONS:

Refer to the FLOOD INSURANCE RATE MAP EFFECTIVE date shown on this map to determine when actuarial rates apply to structures in the zones where elevations or depths have been established.
 To determine if flood insurance is available in this community, contact your insurance agent, or call the National Flood Insurance Program, at (800) 638-6620.



APPROXIMATE SCALE
 1000 0 1000 FEET

NATIONAL FLOOD INSURANCE PROGRAM

FIRM
 FLOOD INSURANCE RATE MAP

CITY OF
 NORTH PORT,
 FLORIDA
 SARASOTA COUNTY

PANEL 5 OF 25
 (SEE MAP INDEX FOR PANELS NOT PRINTED)

COMMUNITY-PANEL NUMBER
 120279 0005 B

EFFECTIVE DATE:
 SEPTEMBER 2, 1981



federal emergency management agency
 federal insurance administration

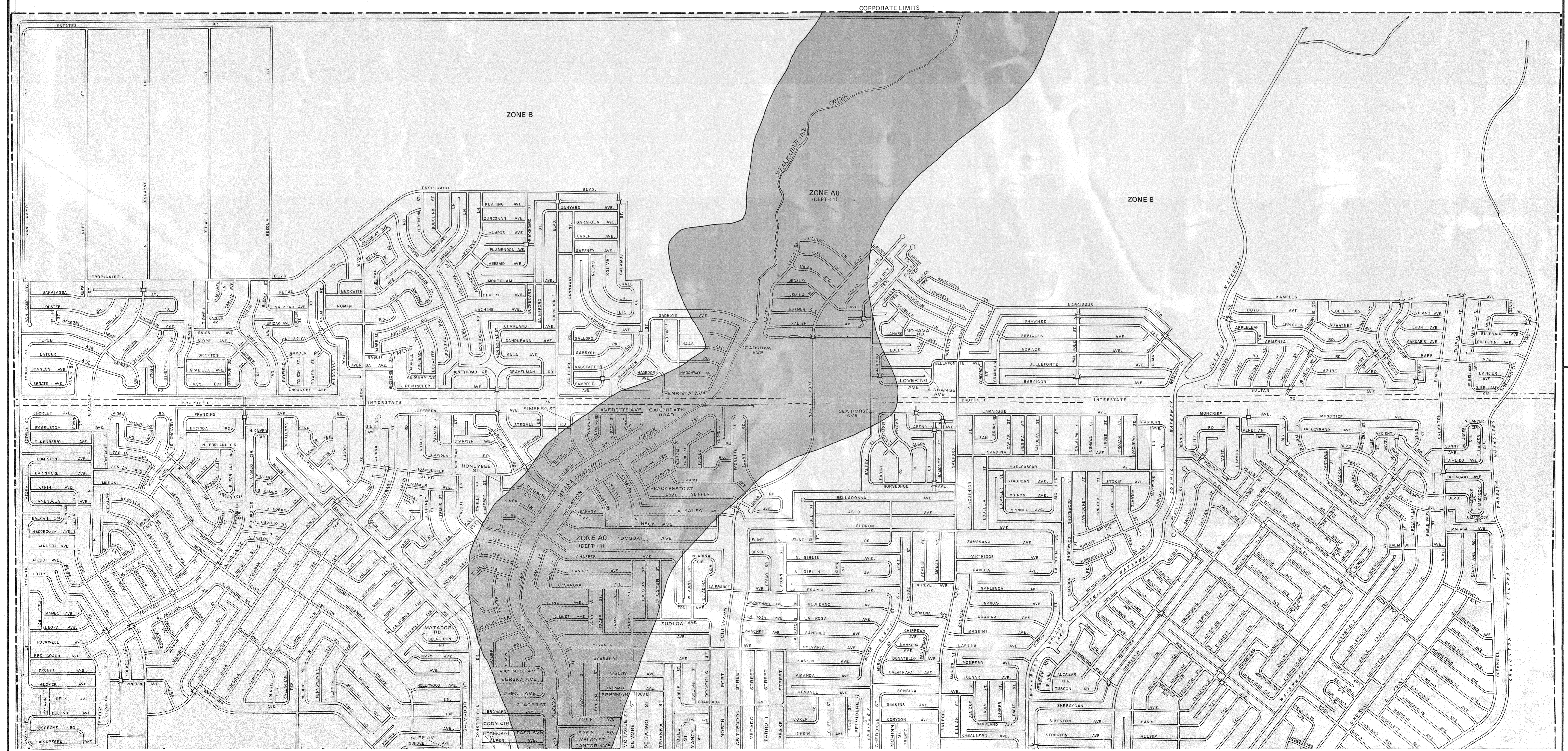

CORPORATE LIMITS

ZONE B

ZONE A0
 (DEPTH 1)

ZONE B

ZONE A0
 (DEPTH 1)